



FITTING INSTRUCTIONS

GasSaver GS-I & GS-I 22BV

Passive Flue Gas Heat Recovery Device

Part No. 720056901 GS-I

720590001 GS-I 22BV (supplied with MULTIFIT 'HeatSaver' package)

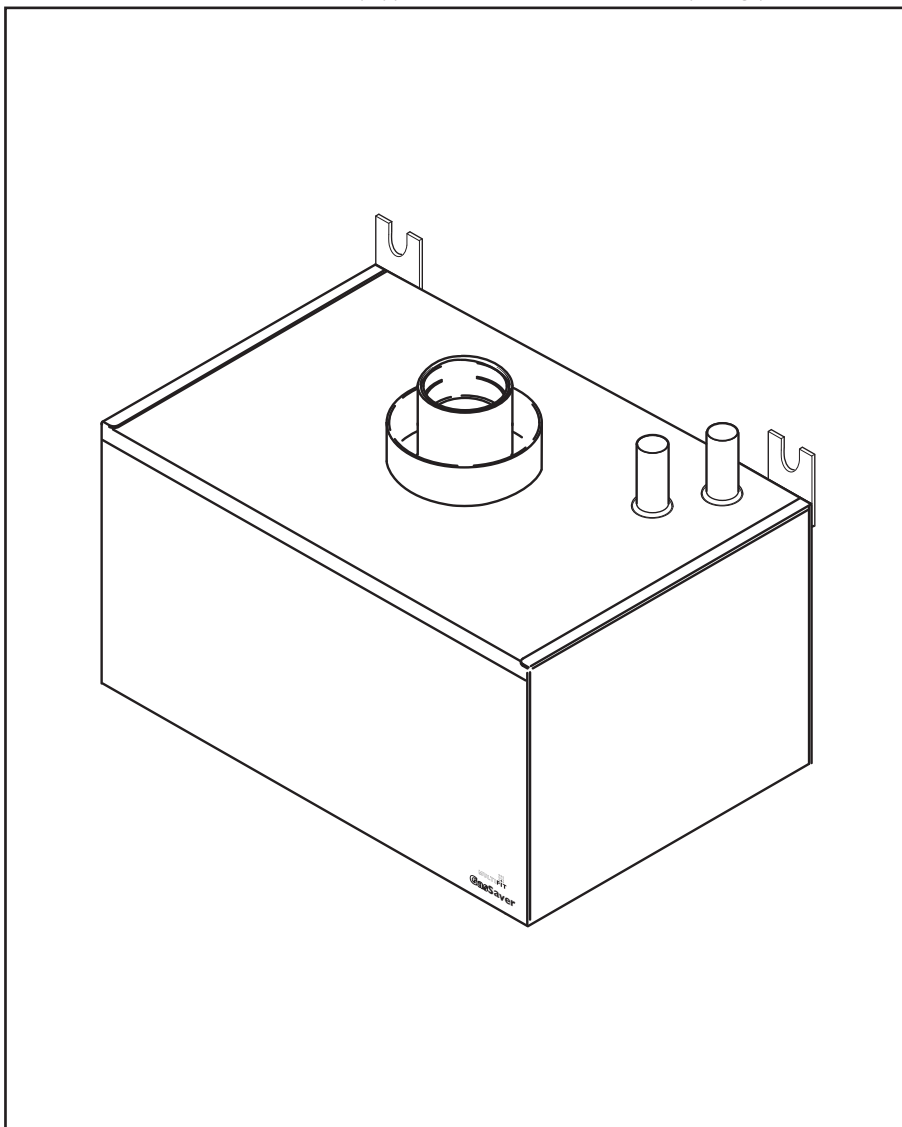

1.0	Introduction	3
2.0	Technical Data	4
3.0	Important Information & Operation	5
4.0	Installation	6
5.0	General Notes	7

The 'GasSaver' GS-I is approved for use with the following boiler models:-

Natural Gas

Baxi Duo-tec Combi 24 HE A
G.C.N° 47 075 35
Baxi Duo-tec Combi 28 HE A
G.C.N° 47 075 36
Baxi Duo-tec Combi 33 HE A
G.C.N° 47 075 37
Baxi Duo-tec Combi 40 HE A
G.C.N° 47 075 38

Baxi Platinum Combi 24 HE A
G.C.N° 47 075 31
Baxi Platinum Combi 28 HE A
G.C.N° 47 075 32
Baxi Platinum Combi 33 HE A
G.C.N° 47 075 33
Baxi Platinum Combi 40 HE A
G.C.N° 47 075 34

Potterton Promax Combi 24 HE Plus A
G.C.N° 47 393 21
Potterton Promax Combi 28 HE Plus A
G.C.N° 47 393 22
Potterton Promax Combi 33 HE Plus A
G.C.N° 47 393 23

Potterton Gold Combi 24 HE A
G.C.N° 47 393 18
Potterton Gold Combi 28 HE A
G.C.N° 47 393 19
Potterton Gold Combi 33 HE A
G.C.N° 47 393 20

Potterton Heatmax Combi 24 HE
G.C.N° 47 393 27
Potterton Heatmax Combi 28 HE
G.C.N° 47 393 28
Potterton Heatmax Combi 33 HE
G.C.N° 47 393 29

Propane

Baxi Duo-tec Combi 24 HE LPG
G.C.N° 47 075 48
Baxi Duo-tec Combi 28 HE LPG
G.C.N° 47 075 39
Baxi Duo-tec Combi 33 HE LPG
G.C.N° 47 075 49

Potterton Promax Combi 24 HE Plus LPG
G.C.N° 47 393 24

Potterton Gold Combi 28 HE LPG
G.C.N° 47 393 30

The 'GasSaver' GS-I 22BV is provided as part of the MULTIFIT 'HeatSaver' Package which also includes a 50 litre Temporal Store Cylinder, and the following boiler model:-

Natural Gas

Baxi Duo-tec Combi 40 HE A
G.C.N° 47 075 38

© Baxi Heating UK Ltd 2010 All rights reserved. No part of this publication may be reproduced or transmitted in any form or by any means, or stored in any retrieval system of any nature (including in any database), in each case whether electronic, mechanical, recording or otherwise, without the prior written permission of the copyright owner, except for permitted fair dealing under Copyrights, Designs and Patents Act 1988.

Applications for the copyright owner's permission to reproduce or make other use of any part of this publication should be made, giving details of the proposed use, to the following address:

The Company Secretary, Baxi Heating UK Ltd,
Brooks House, Coventry Road, Warwick. CV34 4LL

Full acknowledgement of author and source must be given.

WARNING: Any person who does any unauthorised act in relation to a copyright work may be liable to criminal prosecution and civil claims for damages.



1.0 Introduction

1.1 Description

1. The Multifit 'GasSaver' is a 'Zenex GS-1' Passive Flue Gas Heat Recovery Device as listed in the Government's SAP Appendix Q.

2. The Multifit 'GasSaver' uses heat from the flue gases to pre-heat incoming cold mains water, thus reducing gas consumption during the production of Domestic Hot Water.

3. The 'GasSaver' is manufactured under a patent licence from Zenex Technologies Limited.

1.2 Contents of Pack

The pack contains:-

- i) 'GasSaver' Unit
- ii) Support Bracket
- iii) Wall Fixing Screws Pack
- iv) Blending Valve*
- v) Template
- vi) Literature
- vii) SAP Label

*The Blending Valve supplied with GS-1 22BV models incorporates a single check valve.

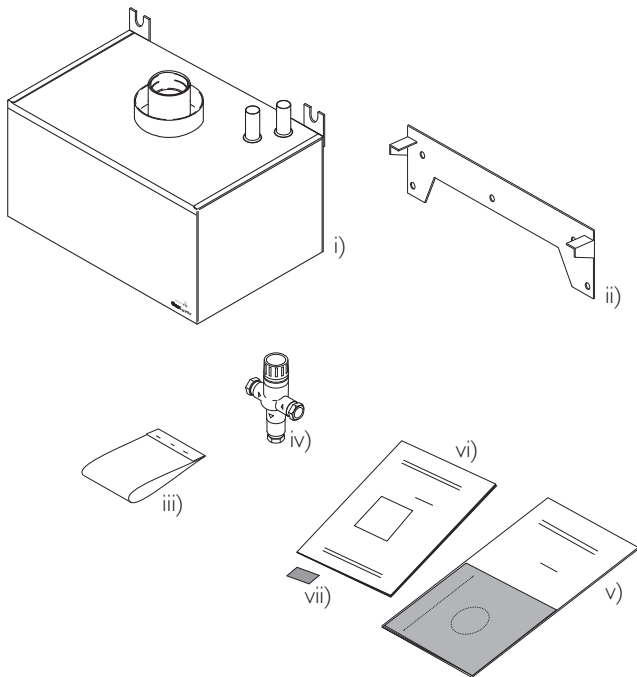

1.3 Flue Lengths

1. To ensure **full boiler output** the following equivalent flue lengths should not be exceeded:-

- 24 models - 5 metres
- 28 models - 5 metres
- 33 models - 3 metres
- 40 models - 1 metre

2. However, further flue lengths or bends **may** be used, but a loss in output of 1% is incurred for every additional metre (or equivalent).

3. The 60/100 **concentric** horizontal or vertical flue system (Flue Group A) approved for the boilers listed on p. 2 **MUST** be used.

NOTE: Maximum permissible equivalent flue length remains at 10 metres.

4. The 'GasSaver' **MUST NOT** be used with twin flue adaptor comp no. 720089801, or any other twin flue system components.

1.4 Accessory

The following items are available as an accessory:-

Expansion Vessel & Check Valve Kit (not required for GS-1 22BV)	720066401
Stand Off Fittings Kit	720079701

2.0 Technical Data

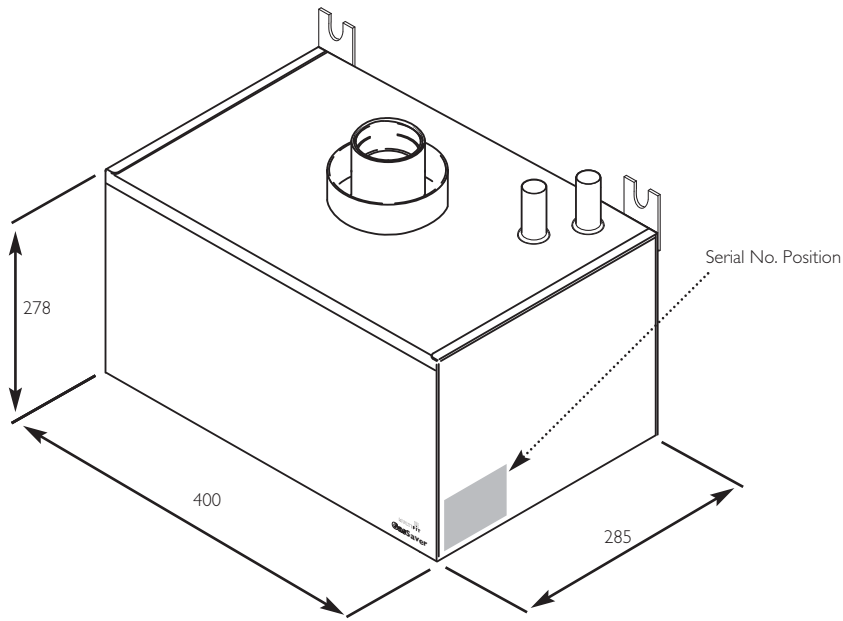

Fig. 1

DHW Circuit Pressures	bar
Max Inlet	- 5*
Min Operating	- 0.2

*if required fit a pressure reducing device to achieve this

DHW Circuit Flow Rates	l/min
Max Flow Rate	- 20
Min Flow Rate	- 2.5

Connections	stainless steel
Cold Water Mains Inlet	- 15mm
Pre-heated Mains Outlet	- 15mm

Dimensions (Fig. 1)	mm
Casing Height	- 278mm
Casing Width	- 400mm
Casing Depth	- 285mm

Weights	kg
Packaged Boiler Carton	- 18.5
Installation Lift Weight	- 15.6
Weight - Full	- 24

Clearances	mm
Above Casing	- 200 mm Min
Below Casing	- 80 mm
Front	- 450 mm Min (For Inspection)
Front	- 5 mm Min (In Operation)
L.H. Side	- 25 mm
R.H. Side	- 25 mm

Blending Valve

GS- I:-	
Connections	- 15mm
Setting Temperature	- 30° C

GS- I 22BV:-	
Connections	- 22mm
Setting Temperature	- 30° C

General

DHW H/Exch.	-	Stainless Steel
Store & Flue Connection	-	Stainless Steel
Casing	-	White Paint - Steel
Condensate Store Capacity	-	5.5 litres
H/Exch Coil Capacity	-	2.7 litres

3.1 Important Information

1. The Multifit 'GasSaver' must only be fitted with one of the boilers specified (see p.2). It must be installed in accordance with these instructions, and by a competent person.
2. The current Gas Safety (Installation & Use) Regulations must be observed, along with all relevant Building Regulations/Standards, Water Regulations/Standards and the B.S. Codes of Practice listed in the boiler instructions.
3. A dedicated wall fixing bracket (Section 1.2, item ii) is supplied to mount the 'GasSaver' on - this **MUST** be used.
4. The 'GasSaver' is in effect part of the flue system and should be considered as such.
5. When using the boiler stand off bracket kit it is also necessary to use the fittings kit 720079701.
6. These instructions must be read in conjunction with those supplied with the boiler.

3.2 Operation (Fig. 2)

1. There are no moving parts or valves in the 'GasSaver' and it does not need any electrical supply. It is fitted to the boiler flue adaptor.
2. The diagram opposite shows how the heat is transferred from the flue gases into the mains cold water.
3. A gas-to-water heat exchanger extracts heat from the discharged products of combustion (hot flue gases). This heat is used to pre-heat the incoming cold mains before it is heated for domestic hot water purposes.
4. During the transfer of heat from the flue gases further condensation occurs, allowing latent heat to be captured. This condensate is utilised to form a thermal store within the 'GasSaver' providing more recovered heat that is used in the pre-heat process.
5. Additionally, as the flue gases leaving the 'GasSaver' contain considerably less moisture, the amount of plumbing is reduced.

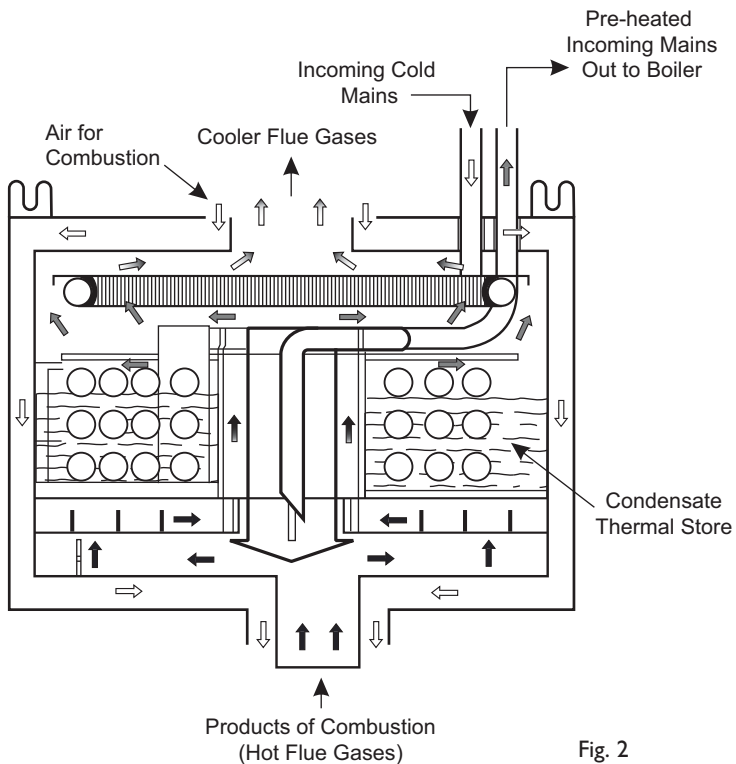

Fig. 2

4.0 Installation

4.1 Installation

1. Follow the Installation & Servicing Instructions supplied with the boiler* to the point at which the wall plate is fitted, but do not mark the flue position.

*Where the MULTIFIT 'HeatSaver' package is used (which includes a GS-I 22BV) additional instructions are provided that refer to the Storage Cylinder and Low Profile Elbow.

2. Align the 'GasSaver' template with the wall plate (Fig. 3) and mark the positions of the flue and upper fixings.

3. Position the 'GasSaver' mounting bracket centrally above the boiler wall plate. Align the smaller flange against the wall plate with the larger flange and two side tabs uppermost (Fig. 4). Mark the most suitable fixing holes.

4. Drill & plug the upper and bracket fixings. Make the hole for the flue.

5. Continue to install the boiler on the wall plate (Fig. 5). Secure the mounting bracket with suitable screws (Fig. 6).

6. The 'GasSaver' can now be fitted. Locate the connection on the underside of the 'GasSaver' in the boiler flue adaptor, taking care to not displace the seals.

7. Whilst supporting the 'GasSaver' secure it to the wall with the screws and washers provided using the upper fixing brackets (Fig. 7).

8. To ensure correct and efficient operation the 'GasSaver' must now be primed (Fig. 8) by pouring 6 litres of clean cold water into the central spigot. **Do not allow any water to spill into the air chamber.**

9. The flue system can now be installed (Fig. 9) and commissioning completed. The flue adaptor on top of the 'GasSaver' is the same as that on the boiler.

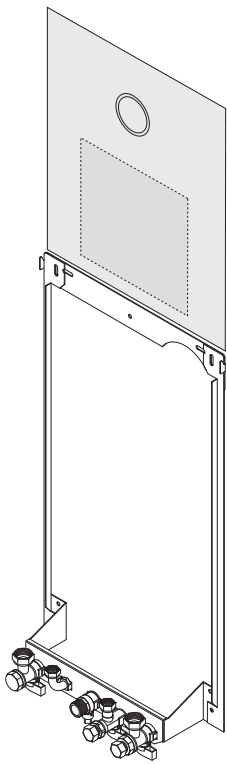

Fig. 3

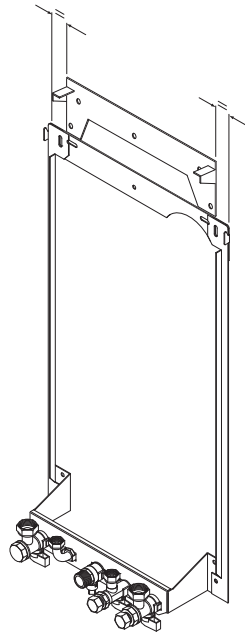

Fig. 4

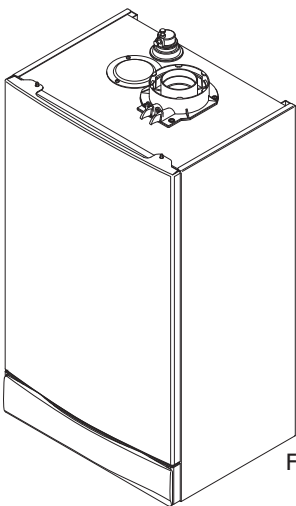

Fig. 5

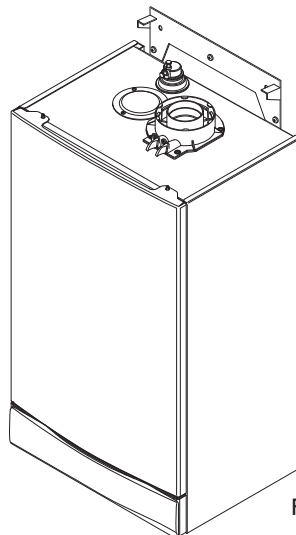

Fig. 6

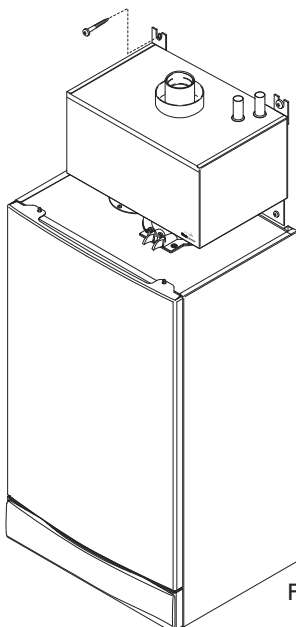

Fig. 7

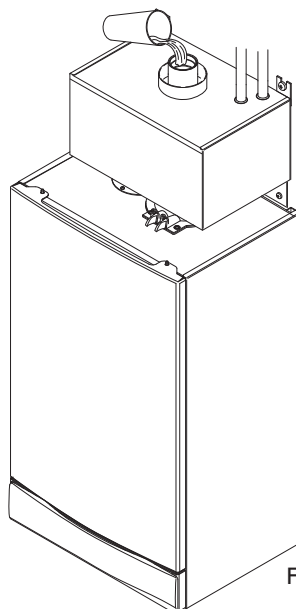

Fig. 8

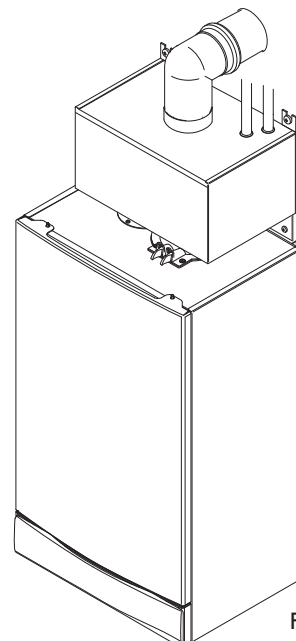

Fig. 9

5.0 General Notes

5.1 Pipework (Figs. 10 & 11)

1. Connect the DHW pipework to the 'GasSaver' using compression fittings that are suitable for use with stainless steel.

IMPORTANT: GS-I 22BV - Where the MULTIFIT 'HeatSaver' package is used (which includes a GS-I 22BV) refer to the instructions provided with it for details of pipework.

NOTE: WRAS certification requires an approved single check valve or some other no less effective backflow prevention device to be fitted at the point of connection between the supply and the device (not applicable to GS-I 22BV version - it is supplied with a combined blending/check valve).

2. The blending valve should be set so that mains water is supplied to the boiler at 30° C. Set it to minimum and check the temperature, adjusting if necessary.

3. Certain circumstances require the installation of an expansion vessel on the mains inlet - see Section 6.0 of the boiler Installation & Servicing Instructions.

4. Apply the SAP label to the boiler door (Fig. 12) and continue with the installation and commissioning procedure.

5. The 'GasSaver' will operate at full effectiveness after approximately 24 hours operation.

5.2 Inspection

1. There are no specific maintenance requirements applicable to the 'GasSaver'.

2. It is recommended that every time the boiler is serviced the 'GasSaver' is subjected to a visual inspection of its overall condition.

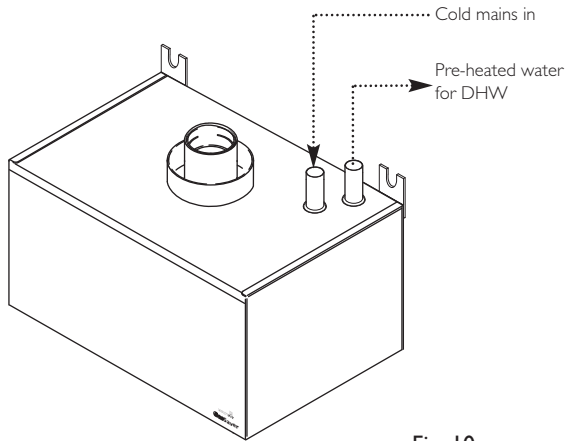

Fig. 10

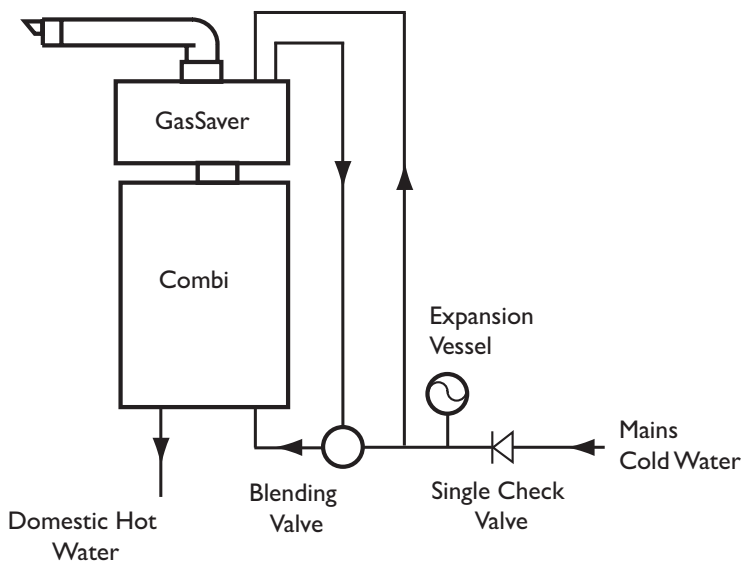

Fig. 11

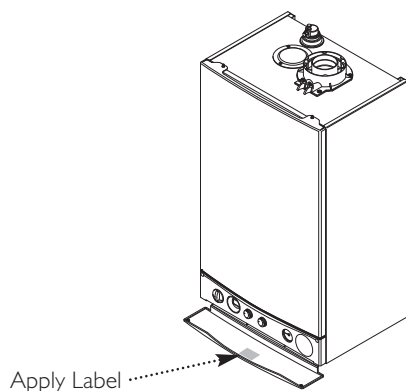

Fig. 12

All descriptions and illustrations provided in this leaflet have been carefully prepared but we reserve the right to make changes and improvements in our products which may affect the accuracy of the information contained in this leaflet. All goods are sold subject to our standard Conditions of Sale which are available on request.

MULTIFIT

A Registered Trademark of Baxi Heating UK Ltd (3879156)

Brooks House, Coventry Road, Warwick. CV34 4LL

Technical Enquiries 0844 871 1555

Websites:- www.baxiheating.co.uk

e&oe



A BAXI GROUP company